

.300 PITCH

SPROCKETS FOR FILM & TAPE

Part No: 210B025D
Pitch: .300
No. Teeth: 10
Material: 303 S/S
Applications: Non-magnetic sprocket may be used with 16mm film perforated per ANSI/SMPTE 109-1992 1R or tape perforated with either .300 or .150 pitch.

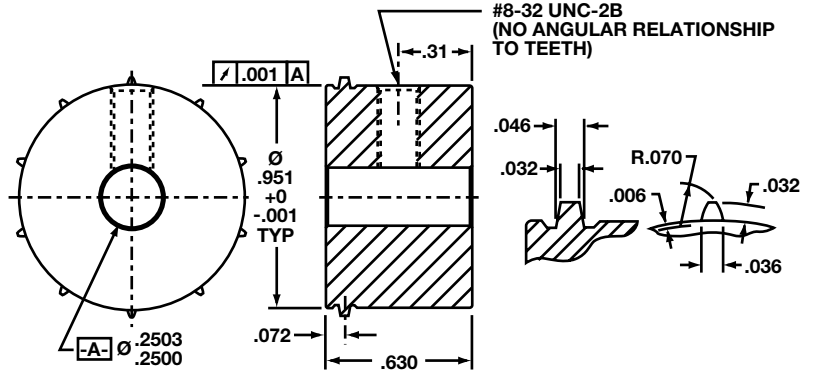

Set screw included.

Part No: See Table
Pitch: .300
No. Teeth: See Table
Material: See Table
Applications: This series of sprockets with a single tooth band is for use with material perforated per ANSI/SMPTE 109-1992. The ground supporting diameters clear the sound track.

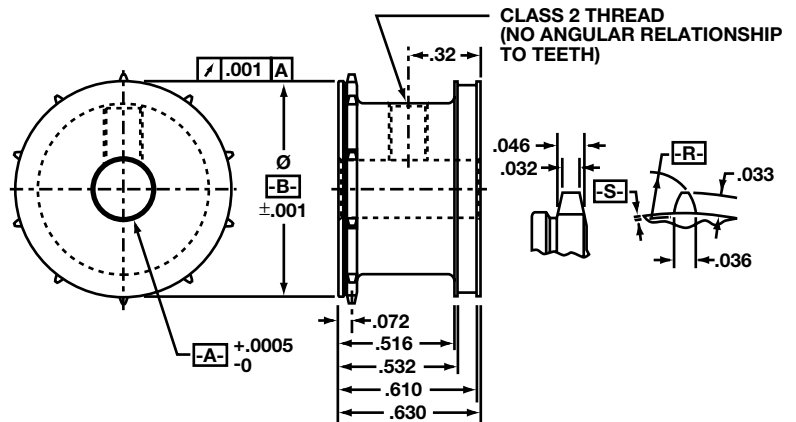

Set screw included.

Note that any of these sprockets can be readily modified for use with Super 16mm film.

Part Number	No. of Teeth	Material	A	B	R	S	Thread
208B25D	8	303 S/S	.2500	.753	.050	.003	#8-32
208B25F	8	416 S/S	.2500	.753	.050	.003	#8-32
210B25D	10	303 S/S	.2500	.947	.070	.0055	#8-32
210B37D	10	303 S/S	.3750	.947	.070	.0055	#8-32
216B31D	16	303 S/S	.3125	1.518	.085	.009	#8-32
216B37D	16	303 S/S	.3750	1.518	.085	.009	#8-32
216B50D	16	303 S/S	.5000	1.518	.085	.009	#8-32
220B31D	20	303 S/S	.3125	1.898	.093	.011	#10-32
220B37D	20	303 S/S	.3750	1.898	.093	.011	#10-32
220B50D	20	303 S/S	.5000	1.898	.093	.011	#10-32

.300 PITCH

SPROCKETS FOR FILM & TAPE

Pitch: .300
Material: 303 S/S

Part No.	Teeth	A	B	R	S
208C25D	8	.2500	.753	.050	.003
210C25D	10	.2500	.947	.070	.0055

Applications: These sprockets are for use with film or tape perforated per ANSI/SMPTE 109-1992 2R.

Set screw included.

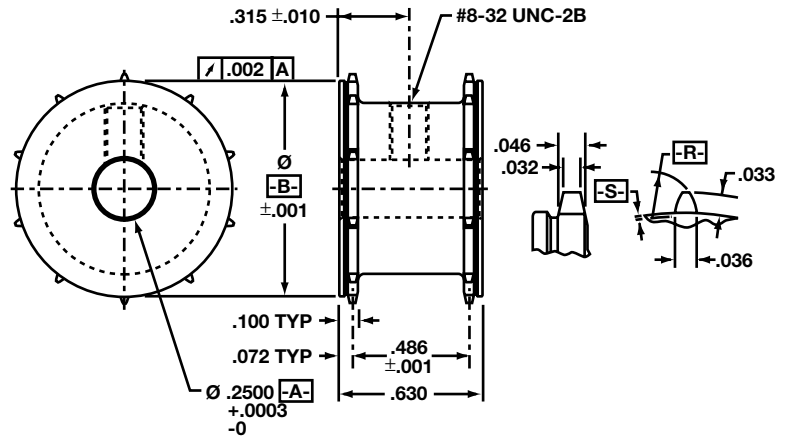

Pitch: .300
Material: 316 S/S

Part No.	Teeth	A	B	R	S
212A68E	12	.6875	1.133	.076	.006
220A75E	20	.750	1.898	.093	.011
220A100E	20	1.000	1.898	.093	.011

Applications: This series of wafer sprockets is made from 316 S/S for use in film processing and cleaning equipment. Only the 20 tooth sprockets have (4) .228 diameter holes on a 1-13/32" B.C. (not related to teeth).

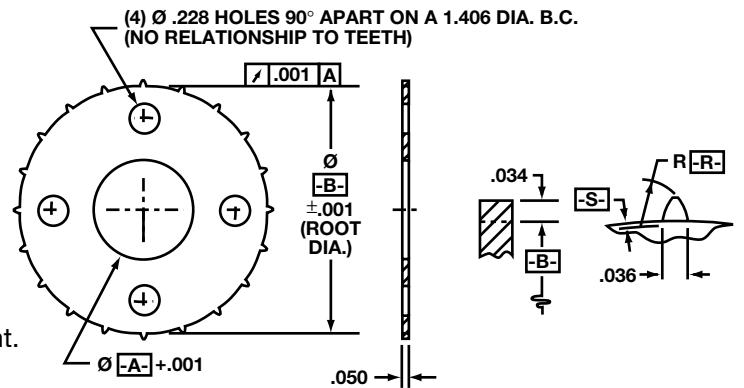

Part No: 240A100J
Pitch: .300
No. Teeth: 40
Material: 2024 Aluminum

Applications: This wafer type sprocket is suitable for use in editing equipment, counters, measuring equipment, etc.....

The four mounting holes are not related to the sprocket teeth.

